

Характеристики

Соединение 1	Наружная резьба NPT
Форма уплотнения 1	Резьбовое уплотнение
Форма уплотнения 2	Внутренний конус 24°
Соединение 2	Метрическая наружная резьба, цилиндрическая
Конструкция	Угол 90°
Модель	Ввертное резьбовое соединение
Норма	DIN 2353 ISO 8434-1
Материал	нержавеющая сталь

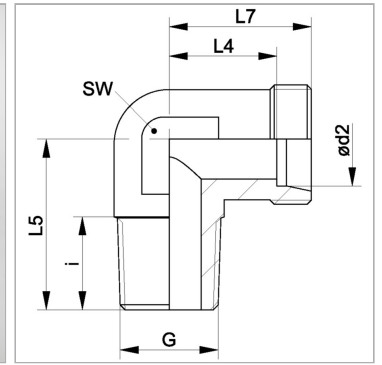

Указания

Указания по монтажу, установке, нагрузке давлением и допустимым рабочим температурам представлены в технической информации для резьбовых трубных соединений.

Комплект поставки

Штуцер (без накидной гайки и режущего кольца)

Артикул

Наименование	Наружный Ø трубы	G	i	L4	L5	L7	Ø d2	SW	Рабочее давление, бар
XWN04LLVA	4	1/8" -27 NPT	8,0	11,0	17,0	15,0	4	9	PN 100
XWN06LLVA	6	1/8" -27 NPT	8,0	9,5	17,0	15,0	6	9	PN 100
XWN08LLVA	8	1/8" -27 NPT	10,0	11,5	20,0	17,0	8	12	PN 100
XWNNW04HLVA	6	1/8" -27 NPT	10,0	12,0	20,0	19,0	6	12	PN 315
XWNNW04HL1/4VA	6	1/4" -18 NPT	12,0	14,0	26,0	21,0	6	12	PN 315
XWNNW04HL3/8VA	6	3/8" -18 NPT	15,3	12,0	28,0	19,0	6	14	PN 315
XWNNW04HL1/2VA	6	1/2" -14 NPT	17,0	23,0	34,0	30,0	6	19	PN 315
XWNNW06HL1/8VA	8	1/8" -27 NPT	10,0	14,0	20,0	21,0	8	12	PN 315
XWNNW06HLVA	8	1/4" -18 NPT	12,0	14,0	26,0	21,0	8	12	PN 315
XWNNW06HL3/8VA	8	3/8" -18 NPT	15,2	11,5	20,0	18,5	8	12	PN 315
XWNNW06HL1/2VA	8	1/2" -14 NPT	17,5	15,0	26,0	22,0	8	12	PN 315
XWNNW08HL1/8VA	10	1/8" -27 NPT	10,0	15,0	22,5	22,0	10	14	PN 315
XWNNW08HLVA	10	1/4" -18 NPT	14,0	15,0	27,0	22,0	10	14	PN 315
XWNNW08HL3/8VA	10	3/8" -18 NPT	15,2	15,0	27,0	22,0	10	14	PN 315
XWNNW08HL1/2VA	10	1/2" -14 NPT	20,0	21,0	34,0	28,0	10	19	PN 315
XWNNW10HL1/4VA	12	1/4" -18 NPT	14,0	17,0	28,0	24,0	12	17	PN 315
XWNNW10HLVA	12	3/8" -18 NPT	12,5	17,0	28,0	24,0	12	17	PN 315
XWNNW13HL3/8VA	15	3/8" -18 NPT	13,0	21,0	34,0	28,0	15	19	PN 315
XWNNW10HL1/2VA	12	1/2" -14 NPT	19,0	23,0	34,0	30,0	12	19	PN 315
XWNNW13HLVA	15	1/2" -14 NPT	18,5	21,0	34,0	28,0	15	19	PN 315
XWNNW16HL3/8VA	18	3/8" -18 NPT	15,3	23,5	31,0	31,0	18	24	PN 315
XWNNW16HLVA	18	1/2" -14 NPT	20,0	23,5	36,0	31,0	18	24	PN 315
XWNNW16HL3/4VA	18	3/4" -14 NPT	18,5	23,5	40,0	31,0	18	24	PN 315
XWNNW20HL1/2VA	22	1/2" -14 NPT	20,0	27,5	42,0	35,0	22	27	PN 160
XWNNW20HLVA	22	3/4" -14 NPT	18,5	27,5	42,0	35,0	22	27	PN 160
XWNNW25HL3/4VA	28	3/4" -14 NPT	20,0	30,5	44,0	38,0	28	36	PN 160
XWNNW25HLVA	28	1" -11,5 NPT	24,0	30,5	48,0	38,0	28	36	PN 160
XWNNW32HLVA	35	1.1/4" -11,5 NPT	25,5	34,5	54,0	45,0	35	41	PN 160
XWNNW40HLVA	42	1.1/2" -11,5 NPT	26,0	40,0	61,0	51,0	42	50	PN 160
XWNNW03HSVA	6	1/4" -18 NPT	12,0	16,0	26,0	23,0	6	12	PN 630
XWNNW03HS3/8VA	6	3/8" -18 NPT	15,3	16,0	28,0	23,0	6	14	PN 630
XWNNW03HS1/2VA	6	1/2" -14 NPT	20,0	16,0	34,0	23,0	6	19	PN 630
XWNNW04HSVA	8	1/4" -18 NPT	15,0	17,0	27,0	24,0	8	14	PN 630
XWNNW04HS3/8VA	8	3/8" -18 NPT	15,3	17,0	28,0	24,0	8	14	PN 630
XWNNW04HS1/2VA	8	1/2" -14 NPT	20,0	17,0	34,0	24,0	8	19	PN 630
XWNNW06HS1/4VA	10	1/4" -18 NPT	15,0	17,5	27,0	25,0	10	17	PN 630
XWNNW06HSVA	10	3/8" -18 NPT	12,0	17,5	28,0	25,0	10	17	PN 630

Наименование	Наружный Ø трубы	G	i	L4	L5	L7	Ø d2	SW	Рабочее давление, бар
XWNNW06HS1/2VA	10	1/2" -14 NPT	20,0	21,5	32,0	29,0	10	19	PN 630
XWNNW08HS1/4VA	12	1/4" -18 NPT	15,0	21,5	27,0	29,0	12	17	PN 630
XWNNW08HSVA	12	3/8" -18 NPT	12,5	21,5	28,0	29,0	12	17	PN 630
XWNNW08HS1/2VA	12	1/2" -14 NPT	20,0	21,5	34,0	29,0	12	19	PN 630
XWNNW10HSVA	14	1/2" -14 NPT	18,0	22,0	34,0	30,0	14	19	PN 630
XWNNW10HS3/8VA	14	3/8" -18 NPT	15,3	22,0	30,0	30,0	14	19	PN 630
XWNNW13HSVA	16	1/2" -14 NPT	19,0	24,5	36,0	33,0	16	24	PN 400
XWNNW13HS3/8VA	16	3/8" -18 NPT	15,3	24,5	28,0	33,0	16	24	PN 400
XWNNW13HS3/4VA	16	3/4" -14 NPT	20,0	24,5	40,0	33,0	16	24	PN 400
XWNNW16HSVA	20	3/4" -14 NPT	20,0	26,6	42,0	37,0	20	27	PN 400
XWNNW16HS1/2VA	20	1/2" -14 NPT	20,0	26,5	42,0	37,0	20	27	PN 400
XWNNW20HSVA	25	1" -11,5 NPT	24,0	30,0	48,0	42,0	25	36	PN 400
XWNNW25HSVA	30	1.1/4" -11,5 NPT	25,5	35,5	54,0	49,0	30	41	PN 400
XWNNW32HSVA	38	1.1/2" -11,5 NPT	26,0	41,0	61,0	57,0	38	50	PN 315

Серия: LL = очень легкая; L = легкая; S = тяжелая

PN = Номинальное давление (бар)

Ø d2 = наружный диаметр трубы

SW = размер под ключ