

### Характеристики

|                          |                              |
|--------------------------|------------------------------|
| <b>Резьба внутренняя</b> | Parallel to DIN EN ISO 228-1 |
| <b>Резьба наружная</b>   | Parallel to DIN EN ISO 228-1 |
| <b>Рабочее давление</b>  | Max. 10 bar                  |
| <b>Материал</b>          | Stainless steel 1.4408       |

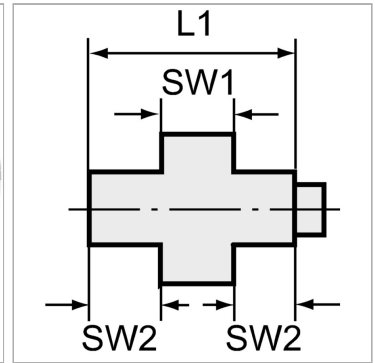

### Указания

Прочие данные только по запросу. The dimensions of the standard screw fittings may change slightly during the life of the catalogue as a result of optimisation processes.

### Артикул

| Наименование               | SW1 | SW2 | Резьба  | L1   |
|----------------------------|-----|-----|---------|------|
| <a href="#">K-07401251</a> | 29  | 18  | G 1/8   | 42,3 |
| <a href="#">K-07401252</a> | 29  | 18  | G 1/4   | 43,0 |
| <a href="#">K-07401253</a> | 34  | 22  | G 3/8   | 46,0 |
| <a href="#">K-07401254</a> | 39  | 26  | G 1/2   | 56,0 |
| <a href="#">K-07401255</a> | 47  | 32  | G 3/4   | 59,7 |
| <a href="#">K-07401256</a> | 58  | 40  | G 1     | 67,0 |
| <a href="#">K-07401257</a> | 67  | 49  | G 1 1/4 | 76,0 |
| <a href="#">K-07401258</a> | 76  | 56  | G 1 1/2 | 81,0 |
| <a href="#">K-07401259</a> | 90  | 68  | G 2     | 89,0 |