

## Distributor blocks, outlets on both sides (front and back)

Обновлено: 04.30.24

### Характеристики

<b>Область температур</b>	-10 °C to +100 °C
<b>Крепление</b>	2 mounting holes in housing (screw size M 5)
<b>Рабочее давление</b>	макс. 10 бар
<b>Материал</b>	алюминий

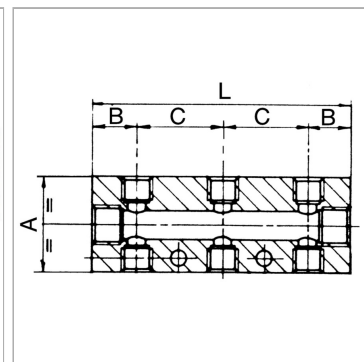

### Указания

Прочие данные только по запросу.

### Описание

For easy assembly of compressed air taps (screw fittings, unions, couplings, etc.).

Optionally with 2, 3, 4, or 6 outlets on one side or both sides.

### Артикул

Наименование	Подключение выходного канала	Подключение входного канала	A	B	C	L
<a href="#">K-07404028</a>	2 + 2 x M 5	2 x 1/8	20,0	15,0	15,0	45,0
<a href="#">K-07405302</a>	3 + 3 x M 5	2 x 1/8	20,0	15,0	15,0	60,0
<a href="#">K-07404029</a>	4 + 4 x M 5	2 x 1/8	20,0	15,0	15,0	75,0
<a href="#">K-07405303</a>	6 + 6 x M 5	2 x 1/8	20,0	15,0	15,0	105,0
<a href="#">K-07404022</a>	2 + 2 x 1/8	2 x 1/4	30,0	15,0	30,0	60,0
<a href="#">K-07405292</a>	3 + 3 x 1/8	2 x 1/4	30,0	15,0	30,0	90,0
<a href="#">K-07404023</a>	4 + 4 x 1/8	2 x 1/4	30,0	15,0	30,0	120,0
<a href="#">K-07405293</a>	6 + 6 x 1/8	2 x 1/4	30,0	15,0	30,0	180,0
<a href="#">K-07404024</a>	2 + 2 x 1/4	2 x 3/8	40,0	18,0	36,0	72,0
<a href="#">K-07405295</a>	3 + 3 x 1/4	2 x 3/8	40,0	18,0	36,0	108,0
<a href="#">K-07404025</a>	4 + 4 x 1/4	2 x 3/8	40,0	18,0	36,0	144,0
<a href="#">K-07405296</a>	6 + 6 x 1/4	2 x 3/8	40,0	18,0	36,0	216,0
<a href="#">K-07404026</a>	2 + 2 x 1/4	2 x 1/2	40,0	22,0	36,0	80,0
<a href="#">K-07405299</a>	3 + 3 x 1/4	2 x 1/2	40,0	22,0	36,0	116,0
<a href="#">K-07404027</a>	4 + 4 x 1/4	2 x 1/2	40,0	22,0	36,0	152,0
<a href="#">K-07405300</a>	6 + 6 x 1/4	2 x 1/2	40,0	22,0	36,0	224,0