

Unidirectional flow control valves with incoming air restriction, adjustable with knurled screw, angled, swivel type, conical male thread, coated

Характеристики

Рабочее давление	Max. 15 bar, coarse vacuum
Область температур	-20 °C to +80 °C
Рабочие среды	Compressed air and all gases or liquids that are compatible with the materials
рекомендуемые шланги	PU or PA (nylon)
Область применения	Air, vacuum
Уплотнительная поверхность	Parallel version: O-ring in housing, Conical version: thread coating
Материал	Plastic, Nickel plated brass
Прижимное кольцо	Plastic

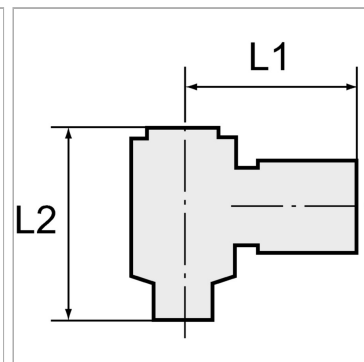

Указания

Прочие данные только по запросу.

Описание

Push-in fittings series manufactured in plastic and nickel-plated brass. All parts are suitable for use with hoses, tubes or pipes made of plastic and copper.

Артикул

Наименование	Резьба	L1	L2 макс.	L2 мин.
K-07400715	R 1/8	22,3	44,0	37,8
K-07400716	R 1/8	22,9	44,0	37,8
K-07400717	R 1/8	25,3	44,0	37,8
K-07400714	R 1/8	30,1	44,0	37,8
K-07400711	R 1/4	24,1	51,0	44,0
K-07400712	R 1/4	24,9	51,0	44,0
K-07400713	R 1/4	28,4	51,0	44,0
K-07400709	R 1/4	32,0	51,0	44,0
K-07400710	R 1/4	32,0	51,0	44,0
K-07400720	R 3/8	26,6	55,0	48,7
K-07400721	R 3/8	29,2	55,0	48,7
K-07400718	R 3/8	32,5	55,0	48,7
K-07400719	R 3/8	35,3	55,0	48,7
K-07400707	R 1/2	29,6	59,2	53,0
K-07400708	R 1/2	32,3	59,2	53,0
K-07400705	R 1/2	35,5	59,2	53,0
K-07400706	R 1/2	36,3	59,2	53,0