

Характеристики

Уплотнение	FKM
Рабочая температура	max. 180 °C
Рабочее давление	0.5 - 60 bar
Корпус	Stainless steel 1.4305
Пружина	Stainless steel 1.4310
Дополнительная информация	Diese Abblasventile sind auch fest eingestellt und mit TÜV-Bauteilprüfnummer lieferbar. Angebot auf Anfrage.

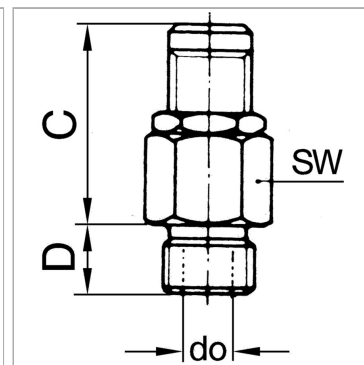

Указания

Прочие данные только по запросу. G thread acc. to DIN EN ISO 228-1, with ISO flange plate (acc. to ISO 5211)

Описание

Manual adjustment of the blow-off pressure (lock nut).

Указание по заказу

For use on devices that have to be vented whenever they are turned off, either because of safety regulations or for technical reasons. The pneumatic devices are disconnected from the system and simultaneously vented each time they are shut off.

Дополнительная информация

These blow-off valves can also be supplied with a fixed setting and a TÜV type test number. Please ask for an offer.

Артикул

Наименование	D	Пропускная способность продувки	Резьба	C	SW	do
K-07302175	7,0	50	G 1/8	27,0	16	3,0
K-07302176	7,0	200	G 1/8	27,0	16	3,0
K-07302177	7,0	350	G 1/8	27,0	16	3,0
K-07302178	7,0	650	G 1/8	27,0	16	3,0
K-07302179	7,0	870	G 1/8	27,0	16	3,0
K-07302180	7,0	1600	G 1/8	27,0	16	3,0
K-07302181	7,0	3000	G 1/8	27,0	16	3,0