

Female connectors, parallel female thread with outer hex

Обновлено: 05.03.24

Характеристики

| | |
|-----------------------------|--|
| Рабочее давление | Max. 15 bar, coarse vacuum |
| Область температур | -20 °C to +80 °C |
| Рабочие среды | Compressed air and all gases or liquids that are compatible with the materials |
| рекомендуемые шланги | PU or PA (nylon) |
| Область применения | Air, vacuum |
| Материал | Plastic, Nickel plated brass |
| Прижимное кольцо | Plastic |

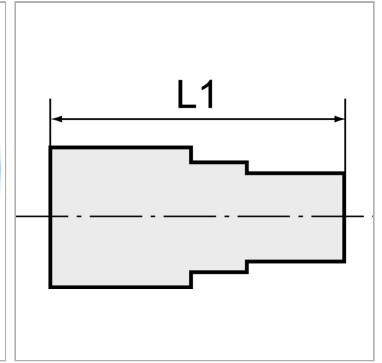
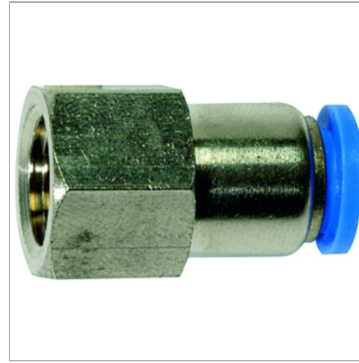

Информация о продукте

| | |
|-------------------------------|-------|
| Резьба | G 1/2 |
| для наружного Ø шланга | 16 mm |

| | |
|-----------|---------|
| L1 | 39.7 mm |
| SW | 24 mm |

Указания

Прочие данные только по запросу.

Описание

Push-in fittings series manufactured in plastic and nickel-plated brass. All parts are suitable for use with hoses, tubes or pipes made of plastic and copper.