

Unidirectional flow control valves with outgoing air restriction, adjustable with knurled screw, angled, swivel type, conical male thread, coated

Характеристики

Рабочее давление	Max. 15 bar, coarse vacuum
Область температур	-20 °C to +80 °C
Рабочие среды	Compressed air and all gases or liquids that are compatible with the materials
рекомендуемые шланги	PU or PA (nylon)
Область применения	Air, vacuum
Уплотнительная поверхность	Parallel version: O-ring in housing, Conical version: thread coating
Материал	Plastic, Nickel plated brass
Прижимное кольцо	Plastic

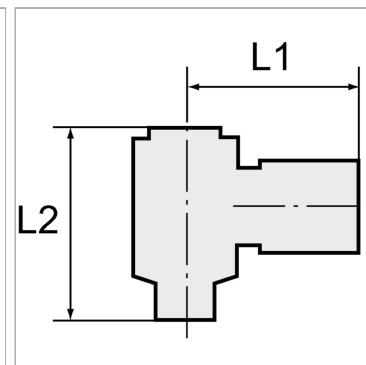

Информация о продукте

Резьба	R 1/8
для наружного Ø шланга	8 mm
L1	24.8 mm

L2 мин.	37.8 mm
L2 макс.	44 mm
SW	10 mm

Указания

Прочие данные только по запросу.

Описание

Push-in fittings series manufactured in plastic and nickel-plated brass. All parts are suitable for use with hoses, tubes or pipes made of plastic and copper.