

## Banjo elbows with parallel female thread, swivel type

Обновлено: 05.03.24

### Характеристики

|                                   |  |
|-----------------------------------|--|
| <b>Рабочее давление</b>           | Max. 15 bar, coarse vacuum   |
| <b>Область температур</b>         | -20 °C to +80 °C   |
| <b>Рабочие среды</b>              | Compressed air and all gases or liquids that are compatible with the materials |
| <b>рекомендуемые шланги</b>       | PU or PA (nylon)   |
| <b>Область применения</b>         | Air, vacuum  |
| <b>Уплотнительная поверхность</b> | Parallel version: O-ring in housing  |
| <b>Материал</b>                   | Plastic, Nickel plated brass   |
| <b>Прижимное кольцо</b>           | Plastic  |

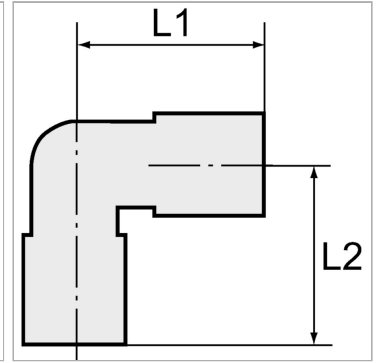

### Информация о продукте

|                               |       |
|-------------------------------|-------|
| <b>Резьба</b>                 | G 3/8 |
| <b>для наружного Ø шланга</b> | 12 mm |
| <b>L2</b>                     | 38 mm |

|           |         |
|-----------|---------|
| <b>L2</b> | 38 mm   |
| <b>L1</b> | 29.3 mm |
| <b>SW</b> | 21 mm   |

### Указания

Прочие данные только по запросу.

### Описание

Push-in fittings series manufactured in plastic and nickel-plated brass. All parts are suitable for use with hoses, tubes or pipes made of plastic and copper.