

## Multiple union elbows with inner hex, 2 outlets, swivel type, conical male thread, coated

### Характеристики

|                                   |  |
|-----------------------------------|--|
| <b>Рабочее давление</b>           | Max. 15 bar, coarse vacuum   |
| <b>Область температур</b>         | -20 °C to +80 °C   |
| <b>Рабочие среды</b>              | Compressed air and all gases or liquids that are compatible with the materials |
| <b>рекомендуемые шланги</b>       | PU or PA (nylon)   |
| <b>Область применения</b>         | Air, vacuum  |
| <b>Уплотнительная поверхность</b> | Conical version: thread coating  |
| <b>Материал</b>                   | Plastic, Nickel plated brass   |
| <b>Прижимное кольцо</b>           | Plastic  |

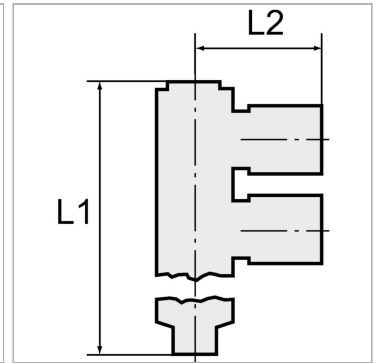

### Информация о продукте

|                                |       |           |         |
|--------------------------------|-------|-----------|---------|
| <b>Резьба</b>                  | R 1/8 | <b>L2</b> | 24.5 mm |
| <b>для наружного Ø шланга</b>  | 8 mm  | <b>L1</b> | 44.3 mm |
| <b>Внутренний шестигранник</b> | 4 mm  | <b>SW</b> | 14 mm   |

### Указания

Прочие данные только по запросу.

### Описание

Push-in fittings series manufactured in plastic and nickel-plated brass. All parts are suitable for use with hoses, tubes or pipes made of plastic and copper.