

## Female connectors, parallel female thread with outer hex

Обновлено: 05.03.24

### Характеристики

|                             |  |
|-----------------------------|--|
| <b>Рабочее давление</b>     | Max. 15 bar, coarse vacuum   |
| <b>Область температур</b>   | -20 °C to +80 °C   |
| <b>Рабочие среды</b>        | Compressed air and all gases or liquids that are compatible with the materials |
| <b>рекомендуемые шланги</b> | PU or PA (nylon)   |
| <b>Область применения</b>   | Air, vacuum  |
| <b>Материал</b>             | Plastic, Nickel plated brass   |
| <b>Прижимное кольцо</b>     | Plastic  |

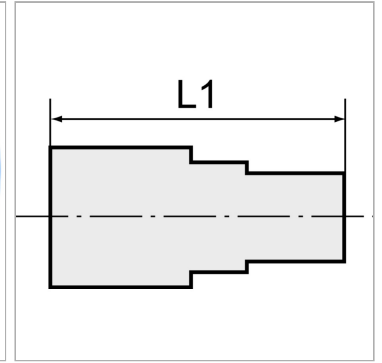
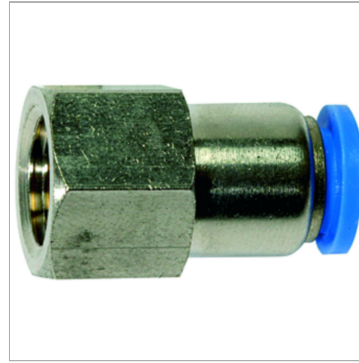

### Информация о продукте

|                               |       |
|-------------------------------|-------|
| <b>Резьба</b>                 | G 3/8 |
| <b>для наружного Ø шланга</b> | 8 mm  |

|           |         |
|-----------|---------|
| <b>L1</b> | 31.1 mm |
| <b>SW</b> | 21 mm   |

### Указания

Прочие данные только по запросу.

### Описание

Push-in fittings series manufactured in plastic and nickel-plated brass. All parts are suitable for use with hoses, tubes or pipes made of plastic and copper.